

VICINITY MAP
NOT TO SCALE

24Th and 122nd DRAINAGE

| SHEET INDEX | |
|-------------|-------------------|
| 1 | COVER |
| 2 | EROSION CONTROL |
| 3 | PLAN AND PROFILE |
| 4 | PLAN AND PROFILE |
| 5 | NOTES AND DETAILS |

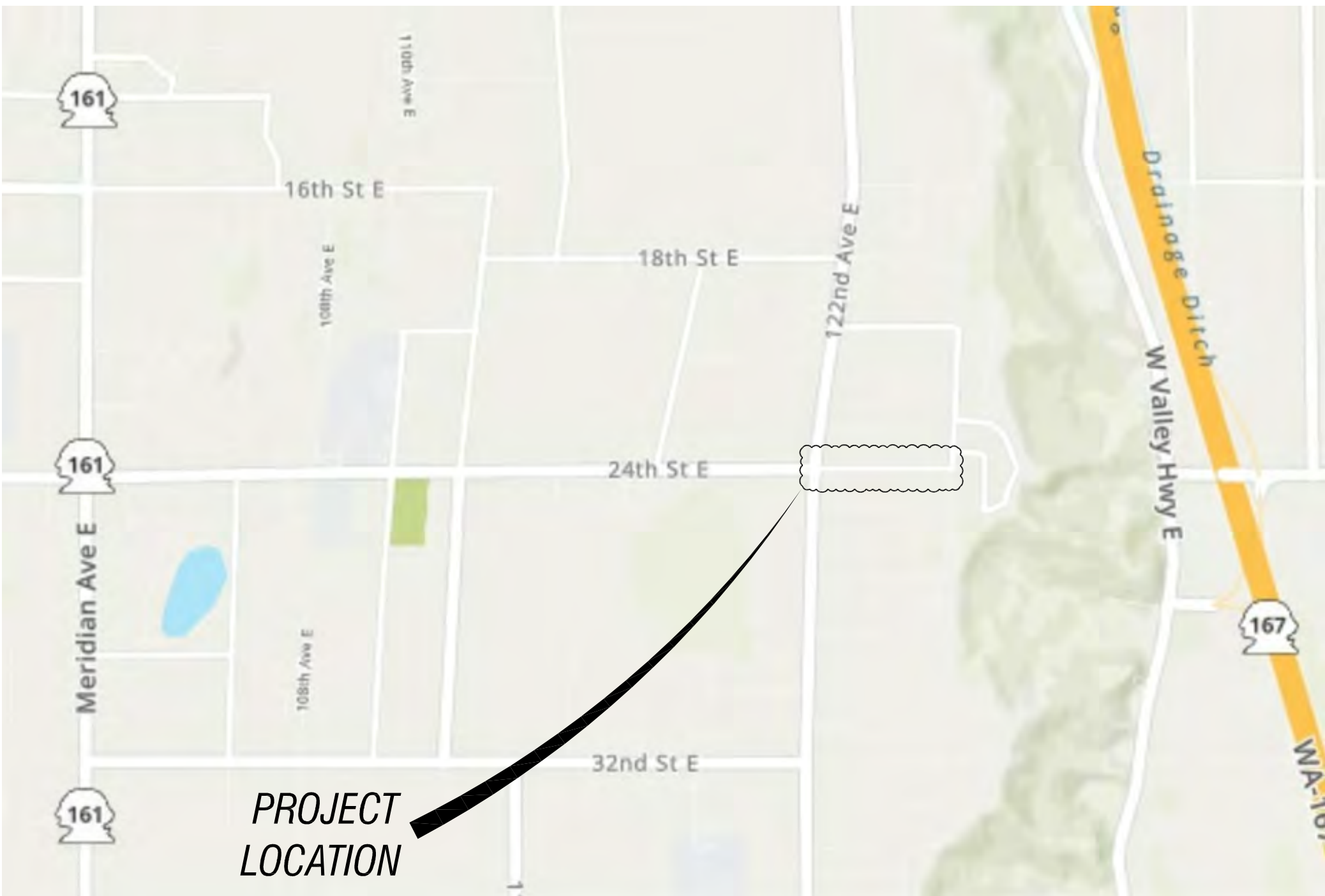

VICINITY MAP
NOT TO SCALE

CITY OFFICIALS

| | |
|----------------|---------------------|
| DARYL EIDINGER | MAYOR |
| MARK CRELEY | COUNCIL POSITION #1 |
| RYAN DAY | COUNCIL POSITION #2 |
| CHRISTI KIETH | COUNCIL POSITION #3 |
| ROSANNE TOMYN | DEPUTY MAYOR |
| JOHN WEST | COUNCIL POSITION #5 |
| ERICA BUCKLEY | COUNCIL POSITION #6 |
| NATE LOWRY | COUNCIL POSITION #7 |

GENERAL NOTE:
EXISTING UTILITY INFORMATION TAKEN FROM FIELD SURVEY PREPARED BY GRAY & OSBORNE, AS-BUILT DRAWINGS, AND UTILITY LOCATES IN THE FIELD. IT IS THE CONTRACTORS RESPONSIBILITY TO VERIFY ALL UTILITIES PRIOR TO CONSTRUCTION.



SURVEY PREPARED BY:



- NOTES**
1. HORIZONTAL DATUM: NAD 83/11 WSPC SOUTH ZONE.
 2. VERTICAL DATUM: NAVD 88
 3. THIS SURVEY WAS PERFORMED USING LEICA GS16 RTK GPS ON THE WA. STATE REFERENCE NETWORK, NAD83-2011 (EPOCH 2010.00) TO ESTABLISH BASIS OF BEARING OF GRID NORTH, WA. COORDINATE SYSTEM, SOUTH ZONE, ALONG SET G&O CONTROL POINT NO'S 7 AND 8, AS SHOWN HEREON. ALL OTHER SURVEY WAS PERFORMED USING A LEICA TORA 1201+ 1 SECOND TOTAL STATION, USING TRAVERSE AND RADIAL SURVEY METHODS. ALL DISTANCES ARE GROUND DISTANCES (AVG. CGF=0.99996477565). SURVEY MEETS AND/OR EXCEEDS ACCURACY REQUIREMENTS CONTAINED IN WAC 332-130-090.
 4. TOPOGRAPHIC SURVEY PERFORMED ON 11/24/2020 THROUGH 12/02/2020 AND REFLECT THE GENERAL CONDITIONS ON THE GROUND AT THAT TIME.
 4. THIS SURVEY DOES NOT PURPORT TO SHOW ALL EASEMENTS OF RECORD OR OTHERWISE.



| | |
|--|-------------|
| CITY OF EDGEWOOD 2224 104th AVENUE EAST EDGEWOOD, WA 98372 | |
| PROJECT NO. | PWSD 22-105 |
| SHEET | 1 OF 5 |

NOTE: CALL 1-800-424-5555 BEFORE YOU DIG.

24Th and 122nd DRAINAGE

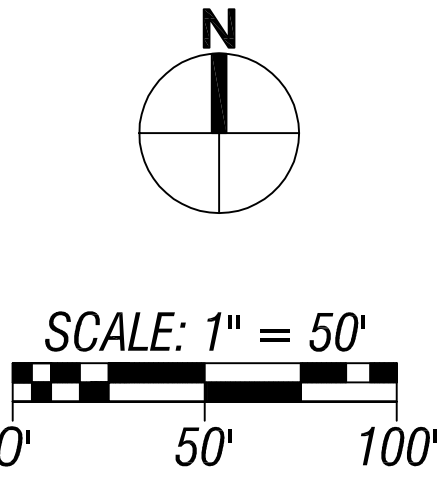
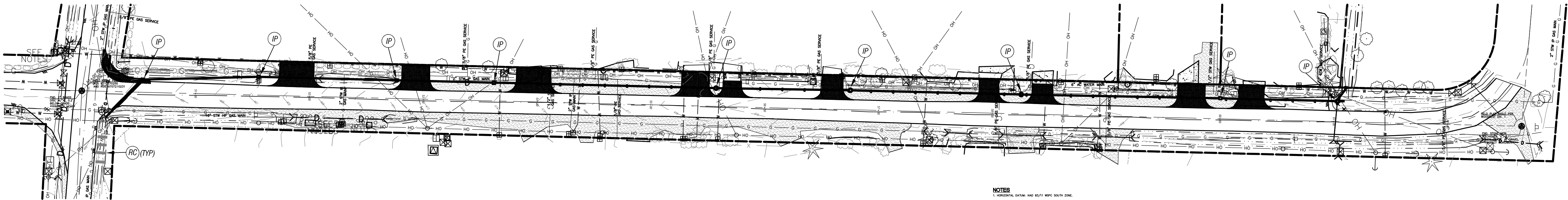

- IP** INSTALL INLET PROTECTION AS PER DETAIL THIS SHEET OTHER APPROVED CB PROTECTION BMPs CAN BE UTILIZED. PAYMENT WILL BE LUMPS SUM FOR EROSION CONTROL.
- SF** INSTALL SILT FENCE AS NEEDED. EXACT LOCATIONS WILL BE DETERMINED IN THE FIELD WITH SITE INSPECTOR AND ENGINEER BASED ON WEATHER PATTERNS AND WORK PROGRESS. PAYMENT WILL BE LUMP SUM FOR EROSION CONTROL.
- RC** INSTALL ROCK CHECK DAMS AS NEEDED IN EXISTING DITCH LINE.

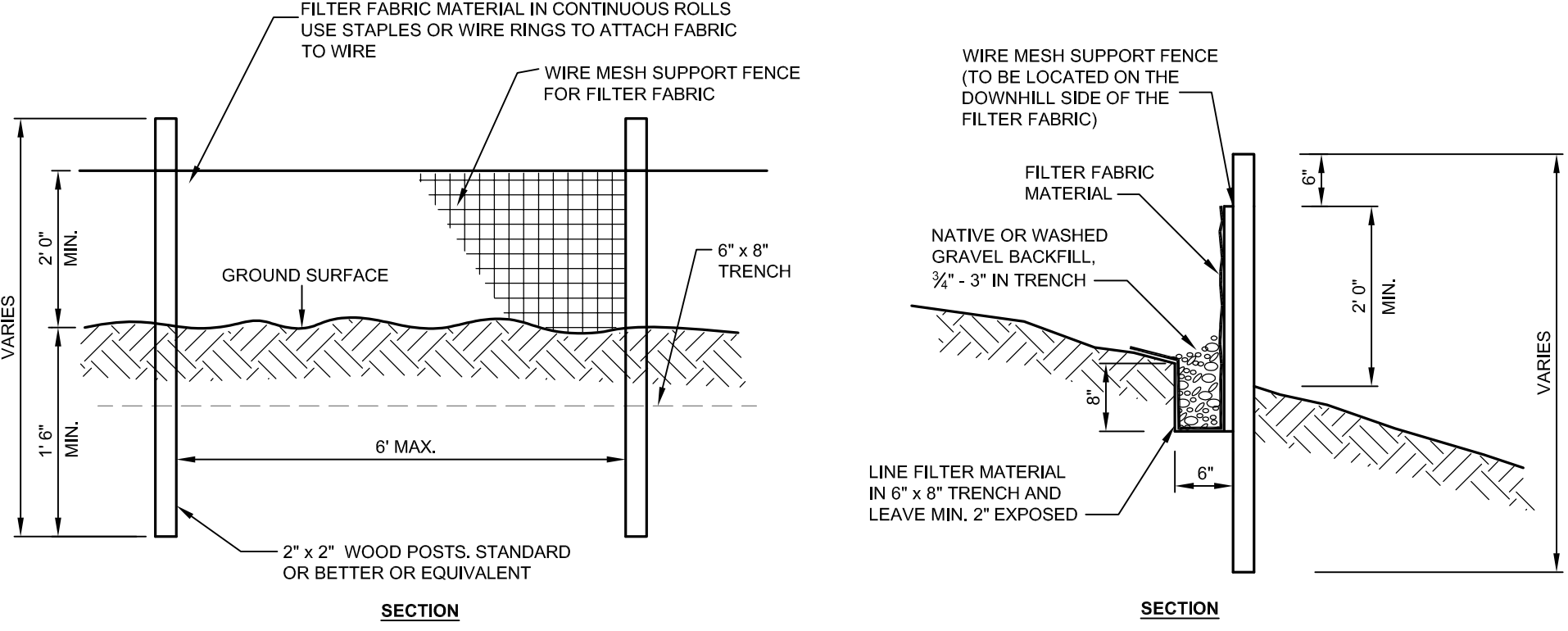
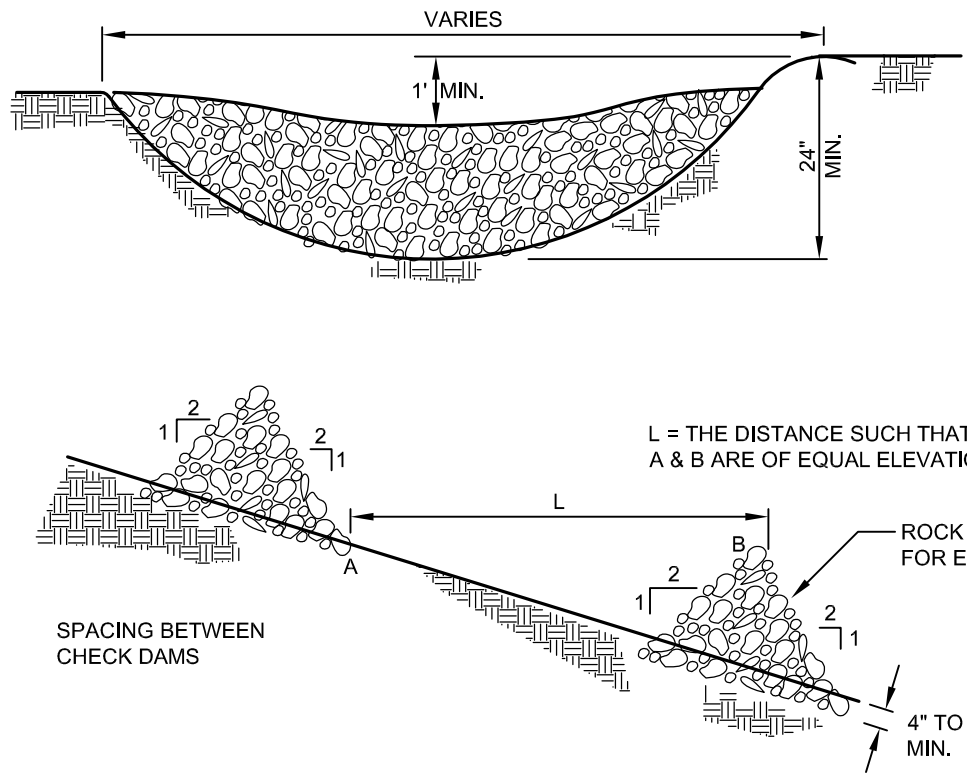

EROSION/SEDIMENTATION CONTROL NOTES

- CONTRACTOR SHALL SUBMIT TEMPORARY WATER POLLUTION/EROSION CONTROL PLAN PER THE CONTRACT SPECIFICATIONS. THESE TESC PLANS ARE NOT INTENDED TO BE COMPLETE. THE CONTRACTOR SHALL PROTECT JOVITA CREEK AND THE STREAMS ABUTTING THE PROJECT.
- ALL LIMITS OF CLEARING AND AREAS OF VEGETATION PRESERVATION SHALL BE OBSERVED DURING CONSTRUCTION.
- ALL REQUIRED SEDIMENTATION/EROSION CONTROL FACILITIES MUST BE IN OPERATION PRIOR TO LAND CLEARING AND/OR OTHER CONSTRUCTION TO ENSURE THAT SEDIMENT LADEN WATER DOES NOT ENTER THE NATURAL DRAINAGE SYSTEM. ALL EROSION AND SEDIMENT FACILITIES SHALL BE MAINTAINED IN A SATISFACTORY CONDITION UNTIL SUCH TIME THAT CLEARING AND /OR CONSTRUCTION IS COMPLETED AND THE POTENTIAL FOR ON-SITE EROSION HAS PASSED. THE IMPLEMENTATION, MAINTENANCE, REPLACEMENT AND ADDITIONS TO EROSION/SEDIMENTATION CONTROL SYSTEMS SHALL BE THE RESPONSIBILITY OF THE CONTRACTOR.
- THE EROSION AND SEDIMENTATION CONTROL SYSTEMS DEPICTED ON THIS DRAWING ARE INTENDED TO BE MINIMUM REQUIREMENTS TO MEET ANTICIPATED SITE CONDITIONS. AS CONSTRUCTION PROGRESSES AND AS UNEXPECTED OR SEASONAL CONDITIONS DICTATE, THE CONTRACTOR SHOULD ANTICIPATE THAT MORE EROSION AND SEDIMENTATION CONTROL FACILITIES WILL BE NECESSARY TO ENSURE COMPLETE SILTATION CONTROL ON THE PROPOSED SITE. DURING THE COURSE OF CONSTRUCTION, IT SHALL BE THE OBLIGATION AND RESPONSIBILITY OF THE CONTRACTOR TO ADDRESS ANY NEW CONDITIONS THAT MAY BE CREATED BY HIS ACTIVITIES AND TO PROVIDE ADDITIONAL FACILITIES, OVER AND ABOVE THE MINIMUM REQUIREMENTS, AS MAY BE NEEDED TO PROTECT ADJACENT PROPERTIES AND THE WATER QUALITY OF THE RECEIVING DRAINAGE SYSTEM.
- AT NO TIME SHALL MORE THAN ONE FOOT OF SEDIMENT BE ALLOWED TO ACCUMULATE WITHIN A CATCH BASIN. THE CONTRACTOR SHALL BE RESPONSIBLE FOR REMOVING AND DISPOSING OF THE SEDIMENT. ALL CATCH BASINS, CONVEYANCE LINES AND DITCHES SHALL BE CLEANED PRIOR TO PAVING.
- THE CONTRACTOR SHALL REMOVE MATERIAL DROPPED, WASHED OR TRACKED FROM VEHICLES ONTO THE TOWN RIGHT-OF-WAY OR INTO THE EXISTING STORM DRAINAGE SYSTEM. DEBRIS SHALL NOT BE WASHED INTO THE STORM DRAINAGE SYSTEM.
- TEMPORARY EROSION CONTROL FACILITIES SHALL BE INSPECTED WEEKLY AND MAINTAINED WITHIN 24 HOURS FOLLOWING A STORM EVENT. SEDIMENT SHALL BE REMOVED TO INSURE THE FACILITIES WILL FUNCTION PROPERLY. THE FACILITIES SHALL BE SATISFACTORILY MAINTAINED UNTIL CONSTRUCTION IS COMPLETED AND THE POTENTIAL FOR ON-SITE EROSION HAS PASSED. ALL STORM DRAIN INLETS MADE OPERABLE DURING CONSTRUCTION SHALL BE PROTECTED SO THAT
- STORMWATER RUNOFF SHALL NOT ENTER THE CONVEYANCE SYSTEM WITHOUT FIRST BEING FILTERED OR OTHERWISE TREATED TO REMOVE SEDIMENT.

ROCK CHECK DAMS
N.T.S.

FILTER FABRIC FENCE DETAIL
N.T.S.

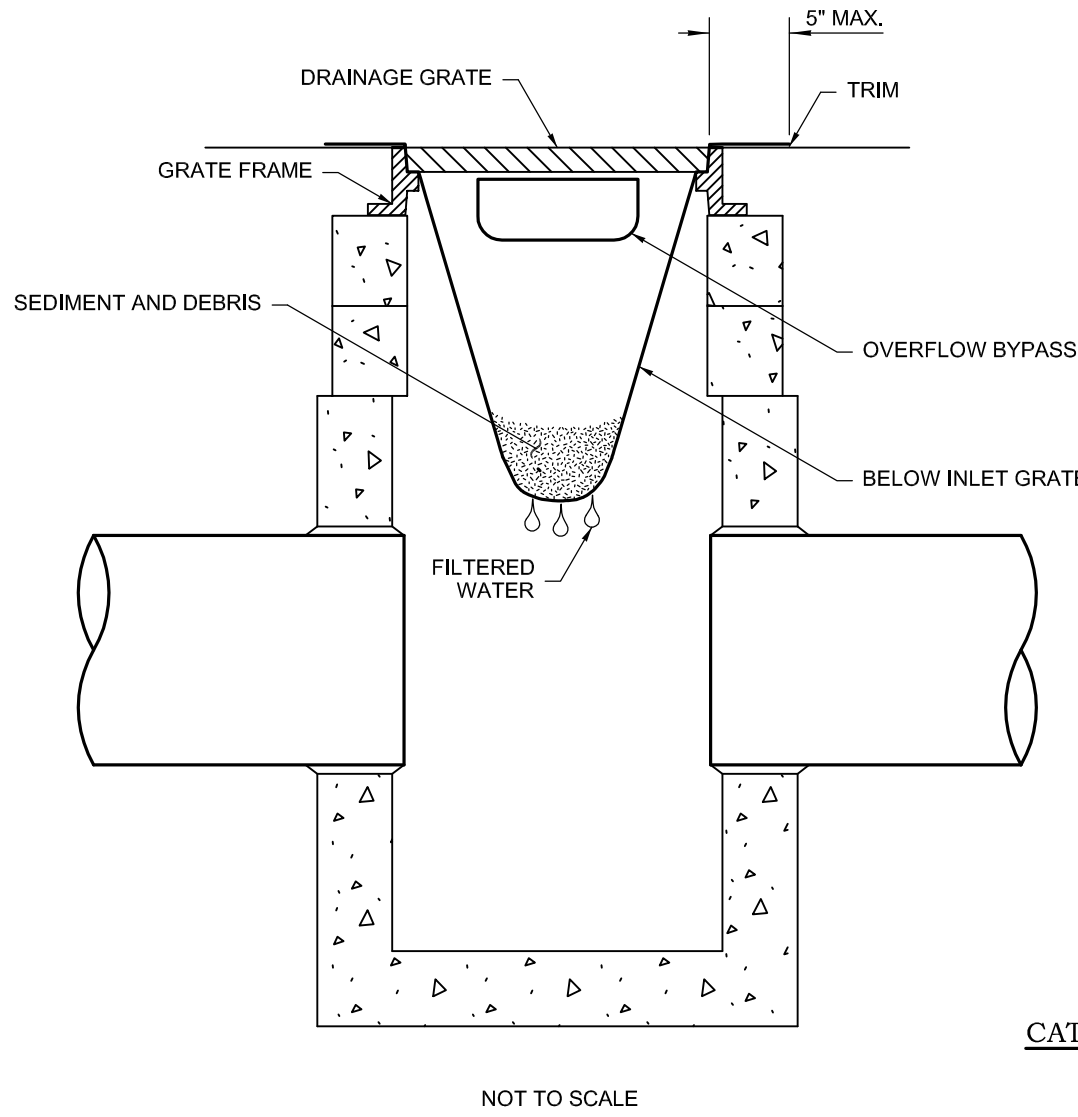

- Size the Below Inlet Grate Device (BIGD) for the storm water structure it will service.
- The BIGD shall have a built-in high-flow relief system (overflow bypass).
- The retrieval system must allow removal of the BIGD without spilling the collected material.
- Perform maintenance in accordance with Standard Specification 8-01.3(15).

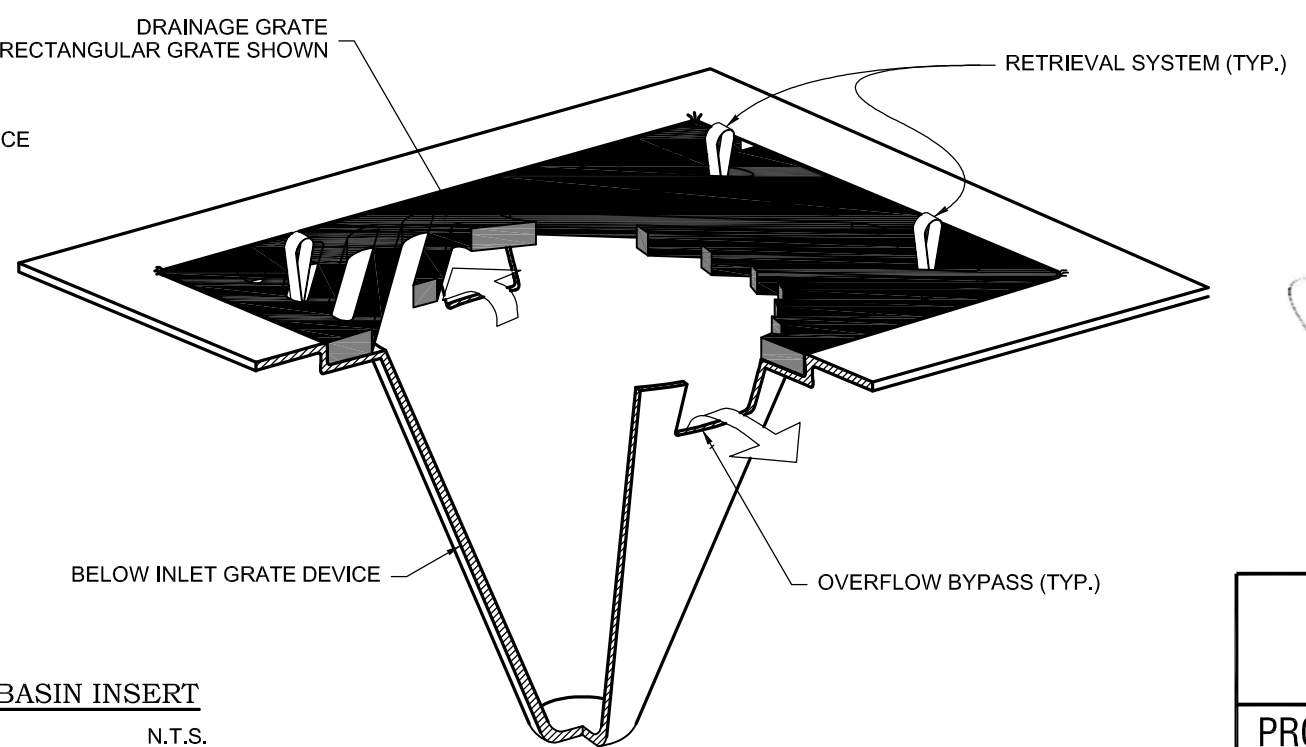

| | |
|--|-------------|
| CITY OF EDGEWOOD 2224 104th AVENUE EAST EDGEWOOD, WA 98372 | |
| PROJECT NO. | PWSD 22-105 |
| SHEET | 2 OF 5 |

24Th STREET EAST DRAINAGE

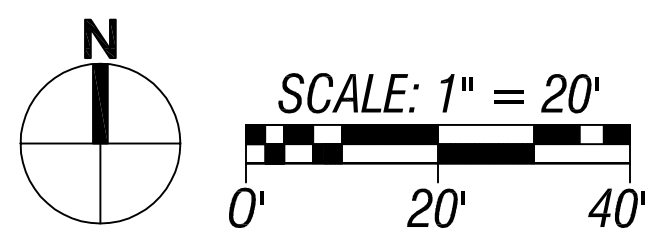

IF THE CITY CHOOSES BID ALTERNATIVE 1, THE CONTRACTOR SHALL CONSTRUCT ROAD WIDENING AS SHOWN. WIDENING SHALL BE AGAINST A CLEAN SAWCUT LINE AND BE 3" COMPACTED DEPTH OF CL $\frac{1}{2}$ " AC, OVER 2" OF CSTC, OVER 12" GRAVEL BASE.

ANY EXISTING HOUSE TIE INS TO THE EXISTING STORM DRAIN SHALL BE CONNECTED TO THE NEW STORM LINE. EXACT QUANTITY IS UNKNOWN. CONTRACTOR TO USE DOWNSPOUT CONNECTION BID ITEM. MEASUREMENT: EACH CONNECTION MADE. BID ITEM: INCLUDES ALL EXCAVATION, MATERIALS, MANPOWER, EQUIPMENT, TOOLS, BACKFILL, TO PERFORM THE WORK. PAYMENT: PER EA.

(SD) CONSTRUCT 12" ADS N-12 STORM DRAIN AT GRADE SHOWN IN PROFILE. MEASUREMENT: LF OF 12" STORM. BID ITEM: INCLUDES ALL EXCAVATION, PIPE, MANPOWER, EQUIPMENT, TOOLS, TRENCH BACKFILL TO PERFORM THE WORK. PAYMENT: PER LF.

(C1) CONSTRUCT TYPE I CATCH BASIN AT GRADES AND LOCATION SHOWN IN PROFILE. MEASUREMENT: EACH TYPE I CONSTRUCTED. BID ITEM: INCLUDES ALL EXCAVATION, MATERIALS, MANPOWER, EQUIPMENT, TOOLS, BACKFILL, RISERS, GROUT, LIDS, GRATES, TO PERFORM THE WORK AND BRING TO FINISHED GRADE. PAYMENT: PER EA.

(C2) CONSTRUCT TYPE II CATCH BASIN AT GRADES AND LOCATION SHOWN IN PROFILE. MEASUREMENT: EACH TYPE II CONSTRUCTED. BID ITEM: INCLUDES ALL EXCAVATION, MATERIALS, MANPOWER, EQUIPMENT, TOOLS, BACKFILL, RISERS, GROUT, COVERS, TO PERFORM THE WORK AND BRING TO FINISHED GRADE. PAYMENT: PER EA.

(SC) SAWCUT EXISTING PAVEMENT TO CREATE A CLEAN EDGE FOR PAVING. MEASUREMENT: LF OF SAWCUTTING COMPLETED. BID ITEM: INCLUDES ALL MANPOWER, EQUIPMENT, TOOLS, TO PERFORM THE WORK. PAYMENT: PER LF.

(DW) CONSTRUCT DRIVEWAY APPROACH AS PER STANDARD DETAIL. MEASUREMENT: PER EACH DRIVEWAY APPROACH CONSTRUCTED. BID ITEM: INCLUDES ALL ASPHALT, MANPOWER, EQUIPMENT, TOOLS NEEDED TO PERFORM THE WORK. PAYMENT: PER EACH DRIVEWAY APPROACH CONSTRUCTED.

(RG) RE-GRADE EXISTING DITCH OR DRESS UP EXISTING SHOULDER. MEASUREMENT: PER SQUARE YARD OF DITCH OR SHOULDER GRADED. BID ITEM: INCLUDES ALL MATERIALS, EQUIPMENT, EXCAVATION, AGGREGATE, MULCH, SEEDING, TOOLS, MANPOWER TO PERFORM THE WORK. PAYMENT: PER SQUARE YARD, MEASURED IN THE FIELD, OF DITCH OR SHOULDER RESTORATION.

(TP) TRENCH PATCH AS PER STANDARD DETAIL. MEASUREMENT: INCIDENTAL TO TONNAGE OF ASPHALT.

(RE) REMOVE AND DISPOSE OF EXISTING STORM PIPE AND/OR STRUCTURE. MEASUREMENT AND PAYMENT WILL BE INCIDENTAL TO LINEAL FEET OF STORM DRAIN.

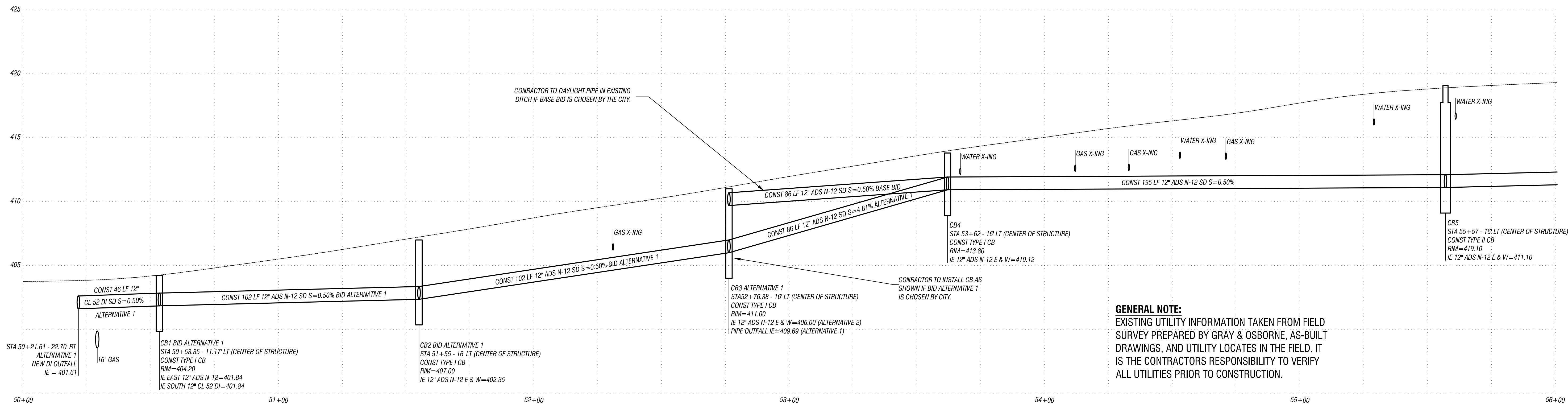
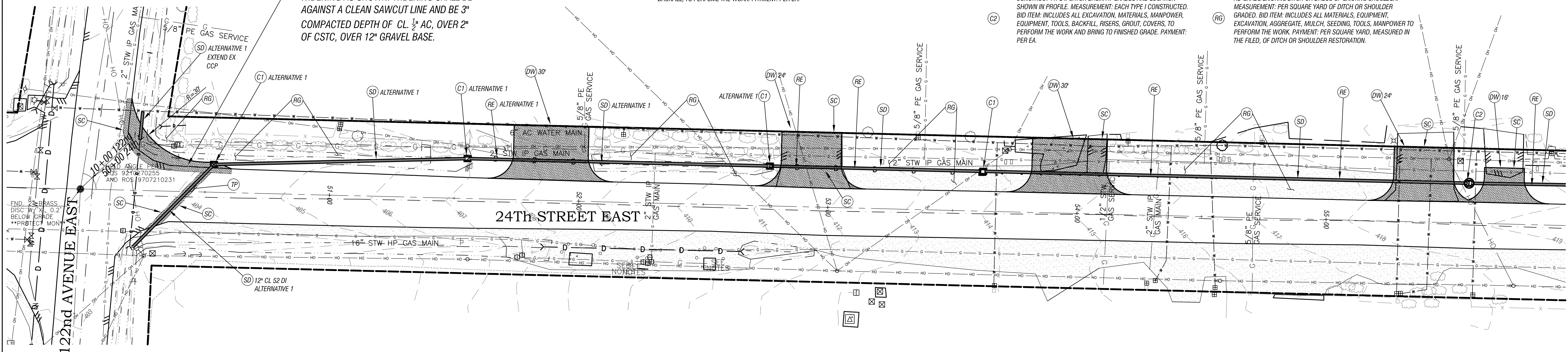

GENERAL NOTE:
EXISTING UTILITY INFORMATION TAKEN FROM FIELD SURVEY PREPARED BY GRAY & OSBORNE, AS-BUILT DRAWINGS, AND UTILITY LOCATES IN THE FIELD. IT IS THE CONTRACTORS RESPONSIBILITY TO VERIFY ALL UTILITIES PRIOR TO CONSTRUCTION.



| | |
|--|-------------|
| CITY OF EDGEWOOD 2224 104th AVENUE EAST EDGEWOOD, WA 98372 | |
| PROJECT NO. | PWSD 22-105 |
| SHEET | 3 OF 5 |

24Th STREET EAST DRAINAGE

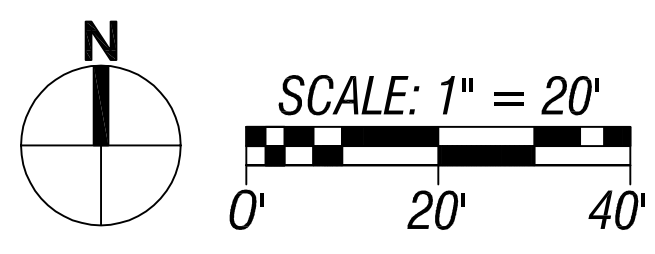

ANY EXISTING HOUSE TIE INS TO THE EXISTING STORM DRAIN SHALL BE CONNECTED TO THE NEW STORM LINE. EXACT QUANTITY IS UNKNOWN. CONTRACTOR TO USE DOWNSPOUT CONNECTION BID ITEM. MEASUREMENT: EACH CONNECTION MADE. BID ITEM: INCLUDES ALL EXCAVATION, MATERIALS, MANPOWER, EQUIPMENT, TOOLS, BACKFILL, TO PERFORM THE WORK. PAYMENT: PER EA.

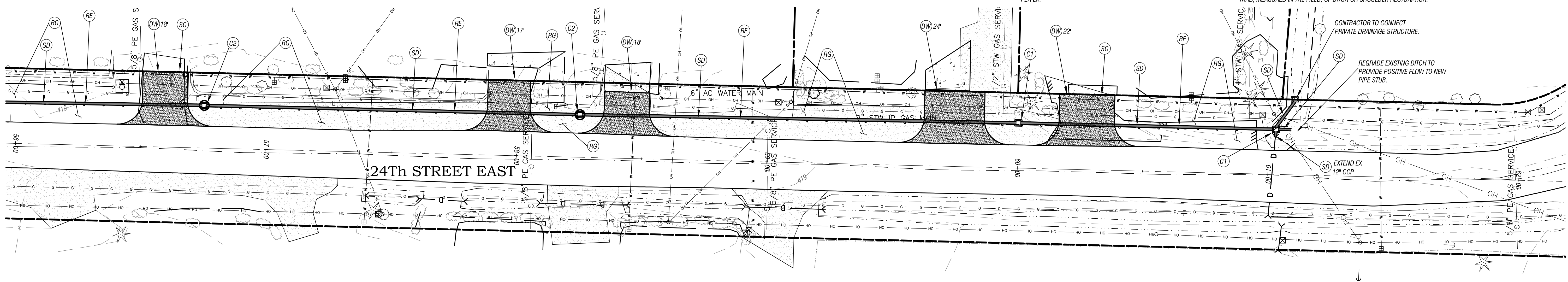

- (SD) CONSTRUCT 12" ADS N-12 STORM DRAIN AT GRADE SHOWN IN PROFILE. MEASUREMENT: LF OF 12" STORM. BID ITEM: INCLUDES ALL EXCAVATION, PIPE, MANPOWER, EQUIPMENT, TOOLS. TRENCH BACKFILL TO PERFORM THE WORK. PAYMENT: PER LF.
- (C1) CONSTRUCT TYPE I CATCH BASIN AT GRADES AND LOCATION SHOWN IN PROFILE. MEASUREMENT: EACH TYPE I CONSTRUCTED. BID ITEM: INCLUDES ALL EXCAVATION, MATERIALS, MANPOWER, EQUIPMENT, TOOLS, BACKFILL, RISERS, GROUT, LIDS, GRATES, TO PERFORM THE WORK AND BRING TO FINISHED GRADE. PAYMENT: PER EA.
- (C2) CONSTRUCT TYPE II CATCH BASIN AT GRADES AND LOCATION SHOWN IN PROFILE. MEASUREMENT: EACH TYPE II CONSTRUCTED. BID ITEM: INCLUDES ALL EXCAVATION, MATERIALS, MANPOWER, EQUIPMENT, TOOLS, BACKFILL, RISERS, GROUT, COVERS, TO PERFORM THE WORK AND BRING TO FINISHED GRADE. PAYMENT: PER EA.
- (SC) SAWCUT EXISTING PAVEMENT TO CREATE A CLEAN EDGE FOR PAVING. MEASUREMENT: LF OF SAWCUTTING COMPLETED. BID ITEM: INCLUDES ALL MANPOWER, EQUIPMENT, TOOLS, TO PERFORM THE WORK. PAYMENT: PER LF.
- (DW) CONSTRUCT DRIVEWAY APPROACH AS PER STANDARD DETAIL. MEASUREMENT: PER EACH DRIVEWAY APPROACH CONSTRUCTED. BID ITEM: INCLUDES ALL ASPHALT, MANPOWER, EQUIPMENT, TOOLS NEEDED TO PERFORM THE WORK. PAYMENT: PER EACH DRIVEWAY APPROACH CONSTRUCTED.
- (RG) FILL EXISTING DITCH OR DRESS UP EXISTING SHOULDER. SHOULDER TO BE MINIMUM OF 3" COMPACTED CSTC. MEASUREMENT: PER SQUARE YARD OF DITCH OR SHOULDER GRADED. BID ITEM: INCLUDES ALL MATERIALS, EQUIPMENT, EXCAVATION, AGGREGATE, MULCH, SEEDING, TOOLS, MANPOWER TO PERFORM THE WORK. PAYMENT: PER SQUARE YARD, MEASURED IN THE FIELD, OF DITCH OR SHOULDER RESTORATION.
- (TP) TRENCH PATCH AS AS PER STANDARD DETAIL. MEASUREMENT: INCIDENTAL TO TONNAGE OF ASPHALT.
- (RE) REMOVE AND DISPOSE OF EXISTING STORM PIPE AND/OR STRUCTURE. MEASUREMENT AND PAYMENT WILL BE INCIDENTAL TO LINEAL FEET OF STORM DRAIN.

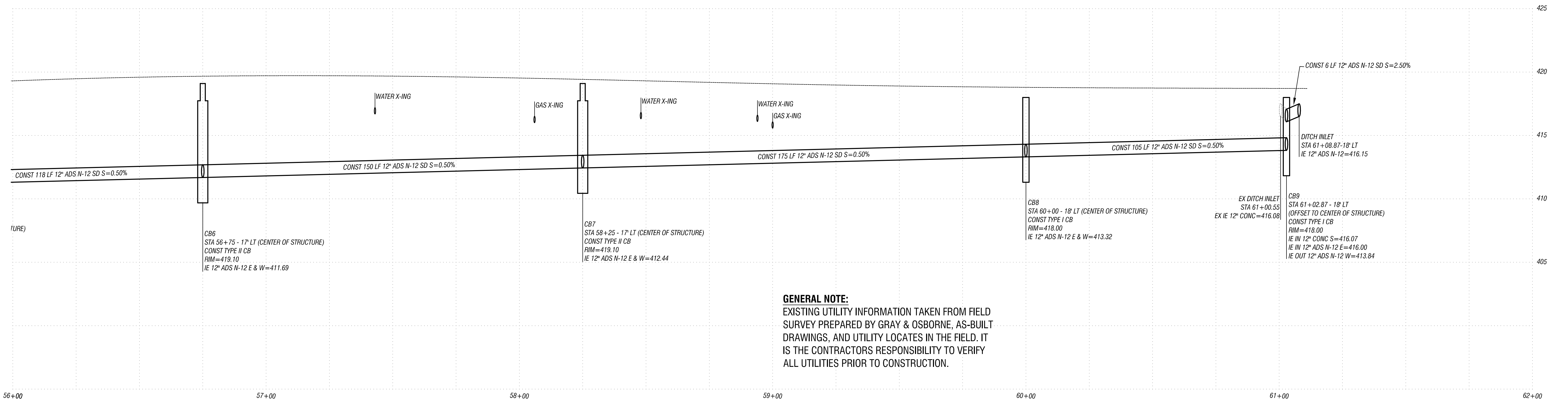

GENERAL NOTE:
EXISTING UTILITY INFORMATION TAKEN FROM FIELD SURVEY PREPARED BY GRAY & OSBORNE, AS-BUILT DRAWINGS, AND UTILITY LOCATES IN THE FIELD. IT IS THE CONTRACTORS RESPONSIBILITY TO VERIFY ALL UTILITIES PRIOR TO CONSTRUCTION.

NOTE: CALL 1-800-424-5555 BEFORE YOU DIG.



| | |
|--|-------------|
| CITY OF EDGEWOOD 2224 104th AVENUE EAST EDGEWOOD, WA 98372 | |
| PROJECT NO. | PWSD 22-105 |
| SHEET | 4 OF 5 |

24Th and 122nd DRAINAGE

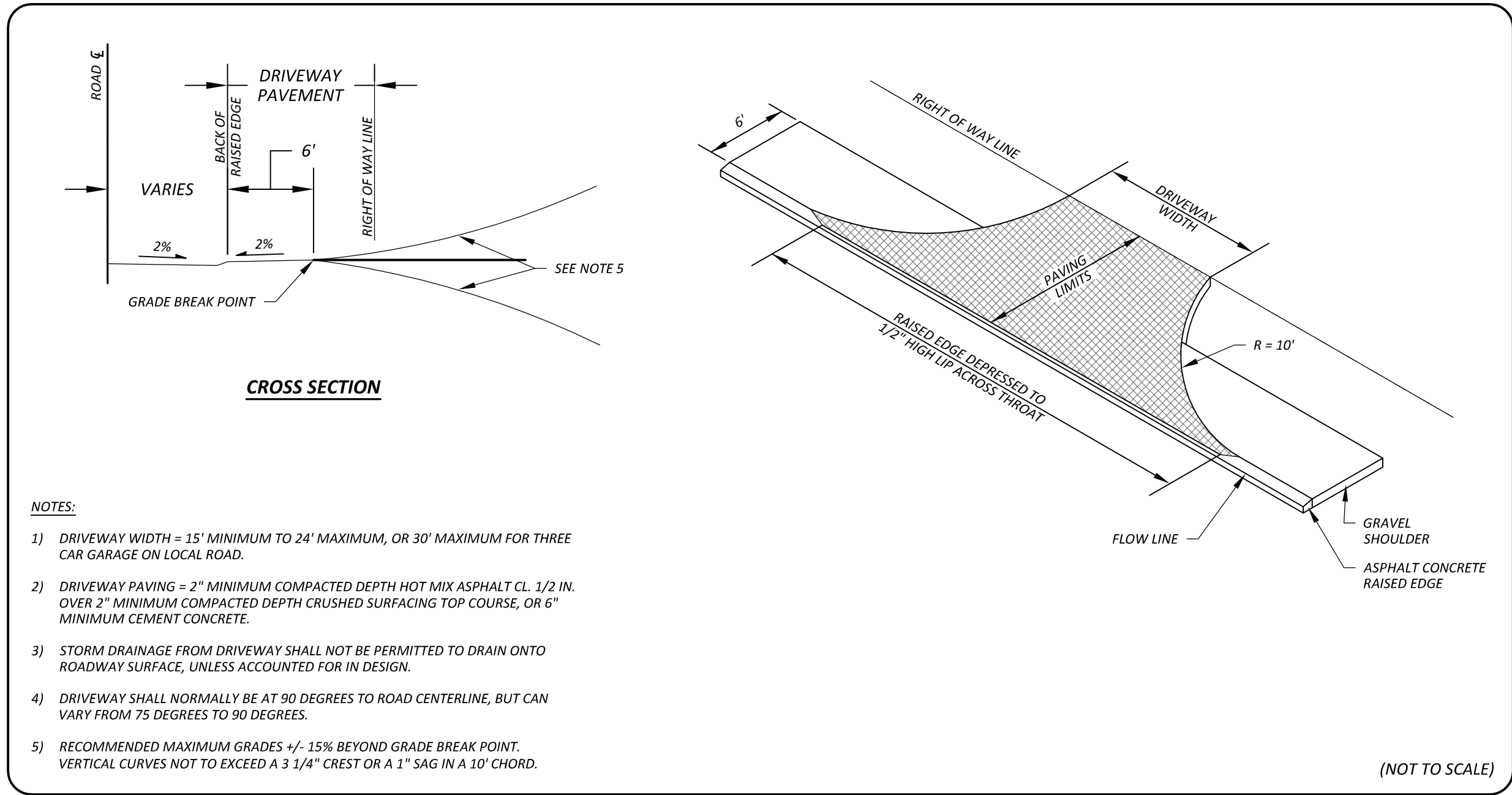

GENERAL NOTES:

1. ALL MATERIALS AND WORKMANSHIP SHALL BE FURNISHED AND SUPPLIED IN ACCORDANCE WITH THE 2018 WASHINGTON STATE DEPARTMENT OF TRANSPORTATION STANDARD SPECIFICATIONS FOR ROAD, BRIDGE, AND MUNICIPAL CONSTRUCTION AND THESE CONTRACT DOCUMENTS UNLESS OTHERWISE SPECIFICALLY NOTED.

2. THE CONTRACTOR SHALL HAVE A COPY OF THESE PLANS, ANY ADDENDA, CHANGE ORDERS, AND THE CONTRACT SPECIFICATIONS ON THE JOB SITE WHENEVER CONSTRUCTION IS IN PROGRESS.

3. THE CONTRACTOR SHALL PROMPTLY NOTIFY THE ENGINEER IN THE EVENT OR DISCOVERY OF UNSUITABLE SOILS OR HIGH GROUND WATER CONDITIONS OR DISCREPANCIES FROM THE PLANS.

4. WHENEVER PLANS REFER TO "SAWCUT" OF ASPHALT PAVEMENT OR OIL MAT, OR CONCRETE SURFACE, THE CONTRACTOR SHALL PERFORM A "NEAT LINE CUT" PER SPECIFICATIONS.

5. PROTECTION OF THE ENVIRONMENT: NO CONSTRUCTION RELATED ACTIVITY SHALL CONTRIBUTE TO THE DEGRADATION OF THE ENVIRONMENT, ALLOW MATERIAL TO ENTER SURFACE OR GROUNDWATERS, OR ALLOW PARTICULATE EMISSIONS TO THE ATMOSPHERE, WHICH EXCEED STATE OR FEDERAL STANDARDS. ANY ACTIONS THAT POTENTIALLY ALLOW A DISCHARGE TO STATE WATERS MUST HAVE PRIOR APPROVAL OF THE STATE OF WASHINGTON DEPARTMENT OF ECOLOGY.

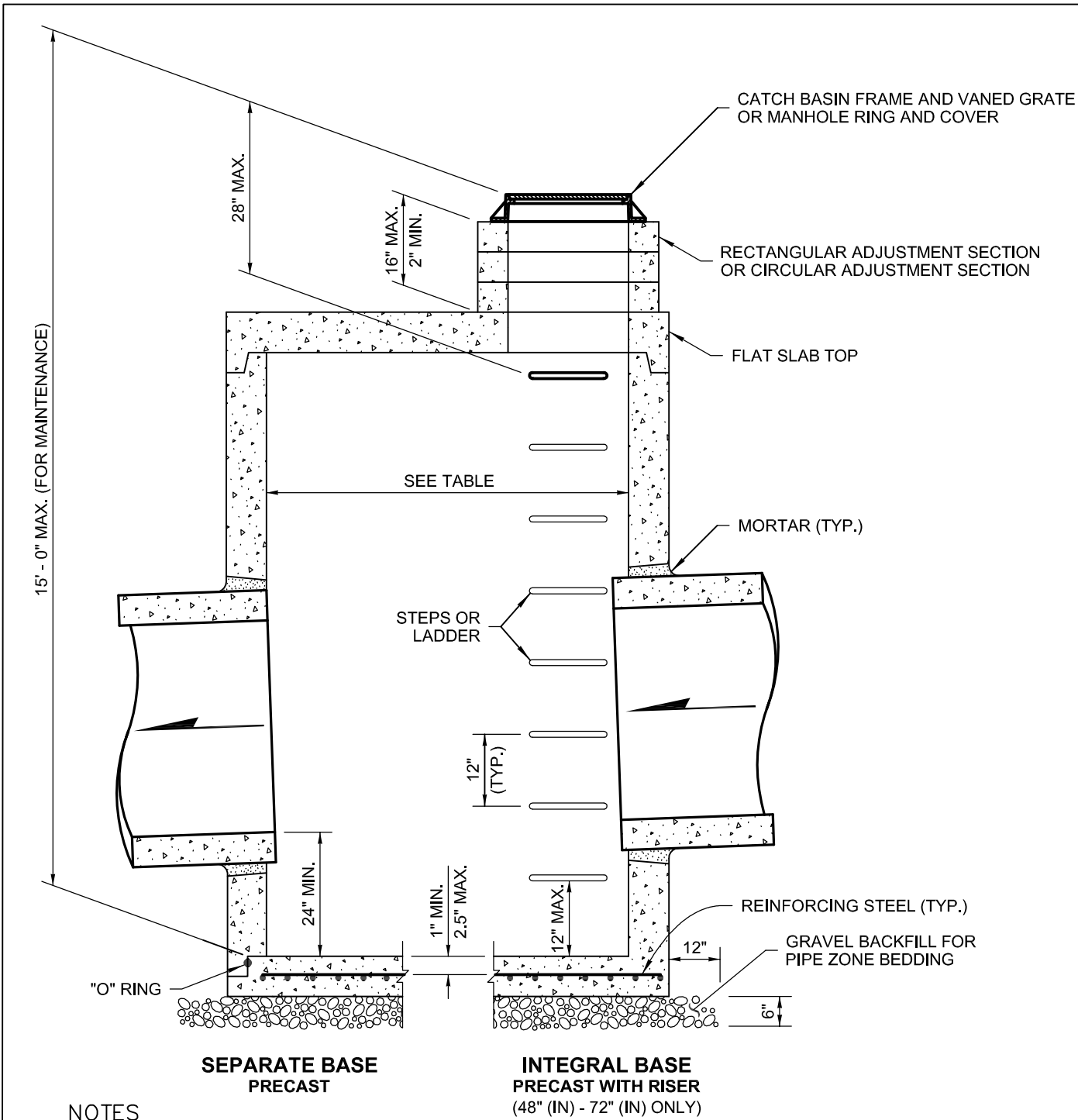

| CATCH BASIN DIMENSIONS | | | | |
|------------------------|---------------------|---------------------|-----------------------|------------------------------------|
| CATCH BASIN DIAMETER | MIN. WALL THICKNESS | MIN. BASE THICKNESS | MAXIMUM KNOCKOUT SIZE | MINIMUM DISTANCE BETWEEN KNOCKOUTS |
| 48" | 4" | 6" | 36" | 8" |
| 54" | 4.5" | 8" | 42" | 8" |
| 60" | 5" | 8" | 48" | 8" |
| 72" | 6" | 8" | 60" | 12" |
| 84" | 8" | 12" | 72" | 12" |
| 96" | 8" | 12" | 84" | 12" |
| 120" | 10" | 12" | 96" | 12" |
| 144" | 12" | 12" | 108" | 12" |

| PIPE ALLOWANCES | | | | | |
|----------------------|--|-----------|---------|------------------|--------------------|
| CATCH BASIN DIAMETER | PIPE MATERIAL WITH MAXIMUM INSIDE DIAMETER | | | | |
| | CONCRETE | ALL METAL | CPSSP ① | SOLID WALL PVC ② | PROFILE WALL PVC ③ |
| 48" | 24" | 30" | 24" | 30" | 30" |
| 54" | 30" | 36" | 30" | 36" | 36" |
| 60" | 36" | 42" | 36" | 42" | 42" |
| 72" | 42" | 54" | 42" | 48" | 48" |
| 84" | 54" | 60" | 54" | 48" | 48" |
| 96" | 60" | 72" | 60" | 48" | 48" |
| 120" | 66" | 84" | 60" | 48" | 48" |
| 144" | 78" | 96" | 60" | 48" | 48" |

- ① Corrugated Polyethylene Storm Sewer Pipe (See **Standard Specification Section 9-05.20**)
② (See **Standard Specification Section 9-05.12(1)**)
③ (See **Standard Specification Section 9-05.12(2)**)
④ Polypropylene Pipe (See **Standard Specification Section 9-05.24**)

CATCH BASIN TYPE 2

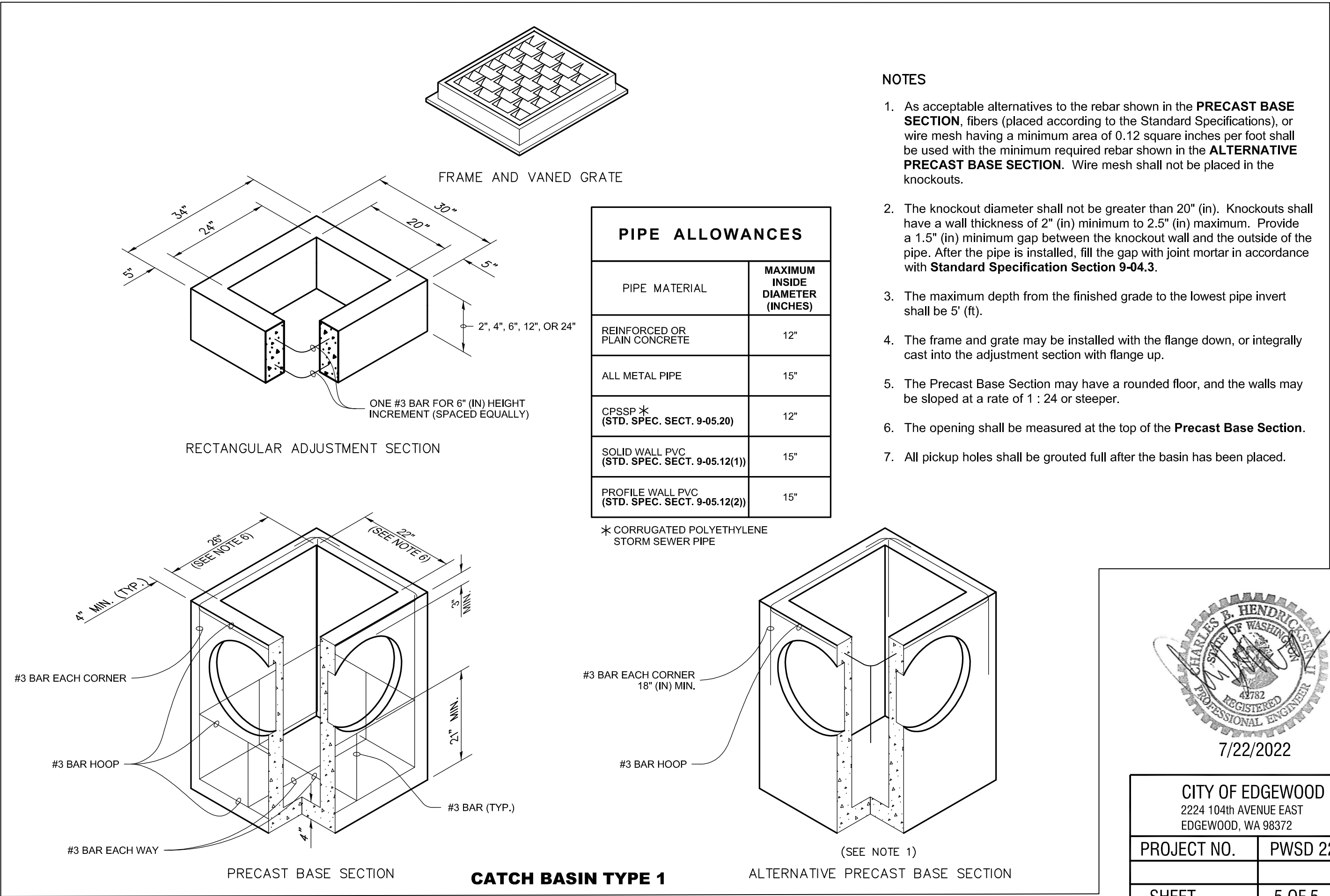

7/22/2022

| | |
|--|-------------|
| CITY OF EDGEWOOD 2224 104th AVENUE EAST EDGEWOOD, WA 98372 | |
| PROJECT NO. | PWSD 22-105 |
| SHEET | 5 OF 5 |